

146-B-62 - SPEEDLINE System Data Sheet - Version V1 (24-10-23)

SPEEDLINE 146mm 'C' Stud Partition @600mm
Ctrs, with 2x BG Gyproc 15mm FireLine each side

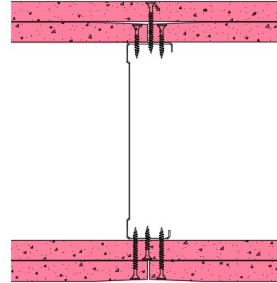

System Performance Breakdown

Fire Resistance:

BS476 Part 22:1987:

Test Ref & Date or Applied Ref & Report:

Max Height:

Thickness:

Duty Grade: BS 5234: Part 2:1992:

Sound Insulation:

120/120 Minutes (Integrity/Insulation).

BTC 17442F - BRE Report P102396-1011A

Refer to Speedline Specification Clause

208 mm. (At Base Track, Excluding Finishes)

Severe - Annexes A-F

47 R_w dB, Date Tested or Assessed Against - 70-B-61

Test Code:
H17498AA
Test Date:
25/07/2011

| Freq. Hz | R dB |
|----------|------|
| 50 | 26.6 |
| 63 | 16.8 |
| 80 | 11.7 |
| 100 | 20.7 |
| 125 | 22.8 |
| 160 | 31.7 |
| 200 | 38.7 |
| 250 | 39.1 |
| 315 | 42.3 |
| 400 | 45.7 |
| 500 | 49.1 |
| 630 | 51.2 |
| 800 | 54.8 |
| 1 000 | 56.4 |
| 1 250 | 58.0 |
| 1 600 | 59.7 |
| 2 000 | 53.7 |
| 2 500 | 44.6 |
| 3 150 | 46.3 |
| 4 000 | 50.2 |
| 5 000 | 53.1 |
| 6 300 | |
| 8 000 | |
| 10 000 | |

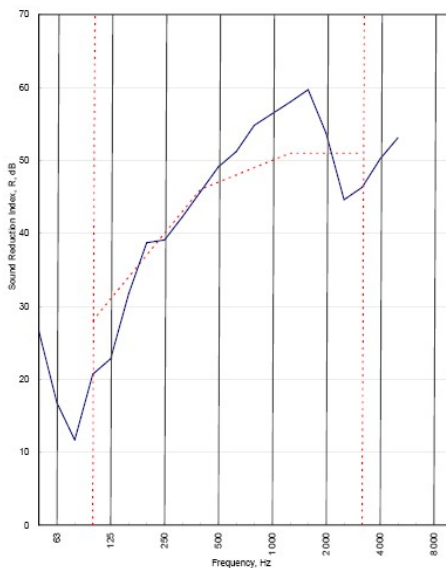

Rating according to BS EN ISO 717-1:1997
 R_w (C;Ctr) = 47 (-3;-9) dB
Max dev. 8.2 dB at 125 Hz

Evaluation based on laboratory measurement results obtained by an engineering method:

| | | |
|-------------------------|-------------------------|-------------------------|
| $C_{50-3150}$ = -6 dB | $C_{50-5000}$ = -5 dB | $C_{100-5000}$ = -2 dB |
| $C_{750-3150}$ = -16 dB | $C_{750-5000}$ = -16 dB | $C_{1100-5000}$ = -9 dB |

TESTED AT ONE OF THE UKAS ACCREDITED LABORATORIES BELOW

B.T.C (H-Ref on Graph) 

B.R.E 

AIRO 

S.R.L 

Customer: Metsec plc Hepsec Division



BTC 17498A: Page 8 of 10

SPEEDLINE Drywall Systems, Adsetts House, 16 Europa View, Sheffield Business Park, Sheffield, S9 1XH.

Tel: 0114 231 8030.

Email: enquiries@speedlinedrywall.co.uk

(As per the requirements set out in ISO/IEC 17025:2017 regarding test data the results stated have been carried out by voestalpine Metsec plc as part of the contract to supply Speedline Metal Sections to SIG Plc)